

1 Place fixing plate where Robe Hook is to be mounted. Mark center position of slotted holes.

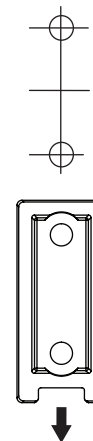

Note: Ensure dimple points downwards

2 Using a 6mm masonry drill bit, drill 2 holes 30mm deep.
For Concrete Wall: Press Plug into Holes.
For Plasterboard: Screw Anchors into Holes

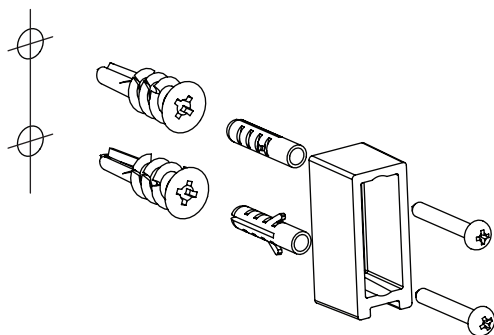

Place mounting plate in position.
Insert screws and tighten firmly with a Phillips Head screwdriver

3 Ensure Mounting Plate is level.

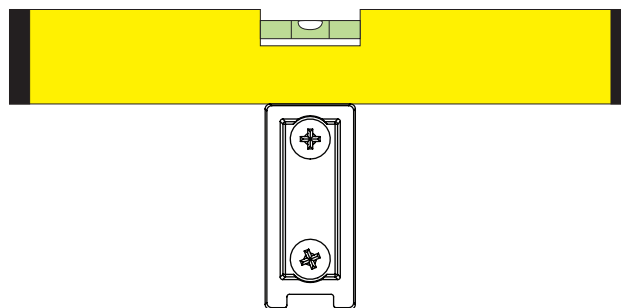

4

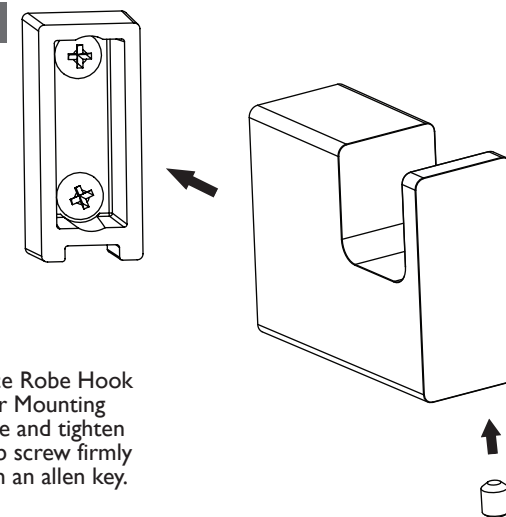

Place Robe Hook
over Mounting
plate and tighten
grub screw firmly
with an allen key.

WARRANTY:

Please refer to the full warranty statement enclosed with the product before installing. Or visit www.phoenixtapware.com.au to download a copy.

MAINTENANCE AND CARE:

- Products should be cleaned with mild liquid detergent or soap and water.
- Do not use cream cleaners or citrus based cleaning products, as they are abrasive.
- Use of unsuitable cleaning agents may damage the surface. Any damage caused in this way will not be covered by warranty.

DISCLAIMER:

While we aim to ensure the specifications shown are correct at the time of printing, Phoenix Tapware reserves the right to make modifications without prior notice. Always use the physical product measurements for mark-ups and roughing-in as the line drawing shown may differ from the actual product over time.

This product is suitable for all construction methods; Timber, brick, rammed earth etc - Provided it is installed to the guidelines specified in this instruction.

*All measurements are shown in millimeters.